

RIB Swivel Fitting Tips

Your RIB swivel comes with all the additional nuts and bolts needed for installation. The included manufacturer's assembly drawings will guide you in combining these extra fixings with your original hardware to ensure a safe and secure fit. Note: The swivel may not rotate freely until it is fully secured to the seat base — this is completely normal, so don't worry if it doesn't spin straight away.

⚠ Security Warnings: Firstly, never drive unless the swivel base is locked facing the road. Secondly, on some vehicles, the driver's seat can only be rotated with the handbrake down. In this case, only rotate the seat on flat ground or after properly wedging the vehicle.

Installation Overview

1. **Remove the seat:** Undo the nuts securing the seat rails to the base box. You'll need to slide the seat forwards and backwards to access all four fixing points. There is no need to remove any seatbelt components.
2. **Fit the handbrake bracket (if included):** If your product includes a handbrake bracket kit, install it now following the fitting diagram provided.
3. **Install the swivel:** Place the swivel onto the base box and secure it using the fixings shown in the assembly drawings. Ensure that the arrow on the top swivel plate points forward, with all product labels facing upward. Tip: Apply Loctite to all bolts to prevent them from loosening over time.
4. **Complete any required modifications:** If the drawings indicate that the seat slider rails need to be trimmed, pins removed, or plastic trim cut, carry out these tasks now.
5. **Cable management (if applicable):** Be cautious with seat cables. Pass them through the central hole, remove any guide clips if needed to provide space, and protect cables using appropriate sheathing.
6. **Refit the seat:** Lift the seat back into place, carefully aligning the seat slider rails with the upper fixing points on the swivel.
7. **Secure the seat:** Fix the seat onto the swivel, again applying Loctite to prevent future loosening. You'll need to slide the seat forward and backward to reach all mounting points.
8. **Set seat height, if required:** If the manufacturer's diagram specifies a fixed seat height and removal of the height adjustment lever, complete this before finalising installation. This ensures proper seatbelt positioning and compliance with EU safety regulations (checked during homologation).

Ongoing Maintenance Advice

Your swivel is pre-greased and adjusted for smooth operation. However, over time, you may need to tighten the central bolt ring to maintain optimal performance. The most common cause of noise is loose fixings — either at the seat base or where the seat mounts to the swivel. To prevent this, always apply Loctite to all fixings during installation.

- Squeaking noises usually indicate that bolts have worked loose. Recheck all mounting points and reapply Loctite if necessary. You can also apply lubricating spray to the stabilisation pins.
- Clicking noises are typically caused by movement in the locking mechanism — applying grease to the metal locking pin should resolve this.

THB = low-profile hex bolt
TBHC = hex socket head bolt (uses an Allen key)



VW Transporter T5-T6.1 – Driver Swivel (RIB V3) Model CBT013G3RV

RIB Fitting Guide - translated by Kiravans

This diagram shows a left-hand drive swivel.
For **right-hand drive swivels** (CBT013G3RGB),
the assembly is **symmetrical**.

Installation note:

On the seat you will need to Trim 30 mm from the bottom edge of both side covers.

4 M8 self-locking nuts

4 M8x20 bolts – tighten to 18 Nm torque

2 M8x10 hex bolts – tighten to 23 Nm torque

Use 2 washers (8x30x1.5 mm)

2 M8x40 bolts – tighten to 23 Nm torque

Swivel plate CBT013G3R

2 front spacers M8 – tighten to 23 Nm

2 rear spacers

Original T5 / T6 seat base

2 original T5 / T6 nuts

2 M8x20 bolts – tighten to 23 Nm torque

2 M8 nyloc nuts

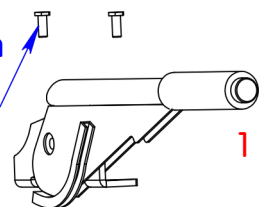

1 Black faux leather cover



A	Version d'origine	23/09/2024	MV
Ind.	Evolution	Date	Par
Montage CBT013G3R pour batterie additionnelle Volkswagen Transporter 5 + 6		MATIERE: TRAITEMENT: -	POIDS: Kg
SCOPEMA - 87150 Oradour-sur-Vayres - France Tel : 05 55 78 11 49 ; Web : www.scopema.com		Tolérances générales Norme ISO 2768-mK	Mécanosoudage- ClasseB NF E 86-050
Client: -	Ref: -	Ech: 1:7	
Ce plan est la propriété de SCOPEMA Il ne peut être communiqué à des tiers ou reproduit sans autorisation écrite de SCOPEMA. This drawing cannot be printed or issued to anybody without SCOPEMA Authorisation		SCOPEMA RIB SEATING SINCE 1981	
		A4	

THB = low-profile hex bolt
TBHC = hex socket head bolt (uses an Allen key)



VW Transporter T5-T6.1 – Passenger Swivel (RIB V3) Model CBTO13D3

RIB Fitting Guide - translated by Kiravans

This diagram shows a left-hand drive swivel.
For **right-hand drive swivels** (CBTO13D3GB),
the assembly is **symmetrical**.

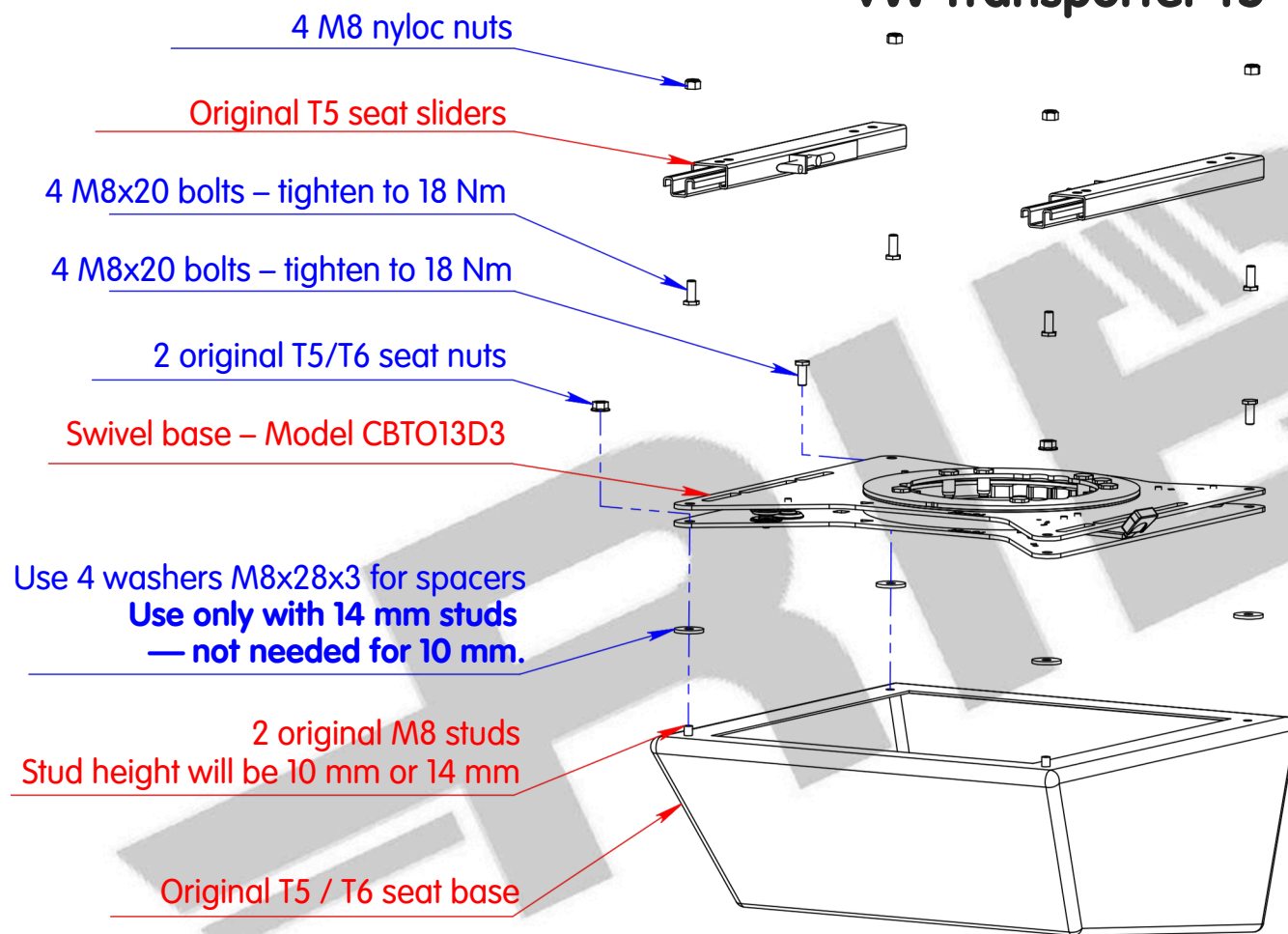

Installation note:

On the seat you will need to Trim 30 mm from the bottom edge of both side covers.

B	Rondelle M8x30x1.5 --> M8x28x3	08/10/2024	AL
A	Version d'origine	23/09/2024	MV
Ind.	Evolution	Date	Par
Montage CBTO13D3 Volkswagen Transporter 5 + 6		MATIERE: TRAITEMENT: -	POIDS: Kg
SCOPEMA - 87150 Oradour-sur-Vayres - France Tel : 05 55 78 11 49 ; Web : www.scopema.com		Tolérances générales Norme ISO 2768-mK	Mécanosoudage- Classe B NF E 86-050
Client: -		Ref: -	Ech: 1:7
Ce plan est la propriété de SCOPEMA Il ne peut être communiqué à des tiers ou reproduit sans autorisation écrite de SCOPEMA. This drawing cannot be printed or issued to anybody without SCOPEMA Authorisation		SCOPEMA RIB SEATING SINCE 1981	A4